

www.zilmetusa.com

info@zilmetusa.com

ZILMET USA LIST PRICE CATALOG

August 2016



ZILMET USA CORP • 400 FRENCHTOWN ROAD, EAST GREENWICH, RHODE ISLAND 02818
P: 401-884-4943 • F: 401-287-4951 • INFO@ZILMETUSA.COM • WWW.ZILMETUSA.COM

Zilmet is one of the oldest and largest expansion tank manufacturers in the world. Established in Italy in 1962, Zilmet is an international manufacturer of quality expansion vessels, pressure tanks and plate heat exchangers with several branches and worldwide distribution.

Zilmet is an ISO 9001 certified company that produces in excess of 7 million tanks and 1 million heat exchangers every year. We take great pride in our globally renowned quality and service and look forward to sharing our story and products with you and your customers.

With our North American Headquarters in East Greenwich, Rhode Island, Zilmet is proudly introducing new products for the hydronic, water system and solar industry into North America.

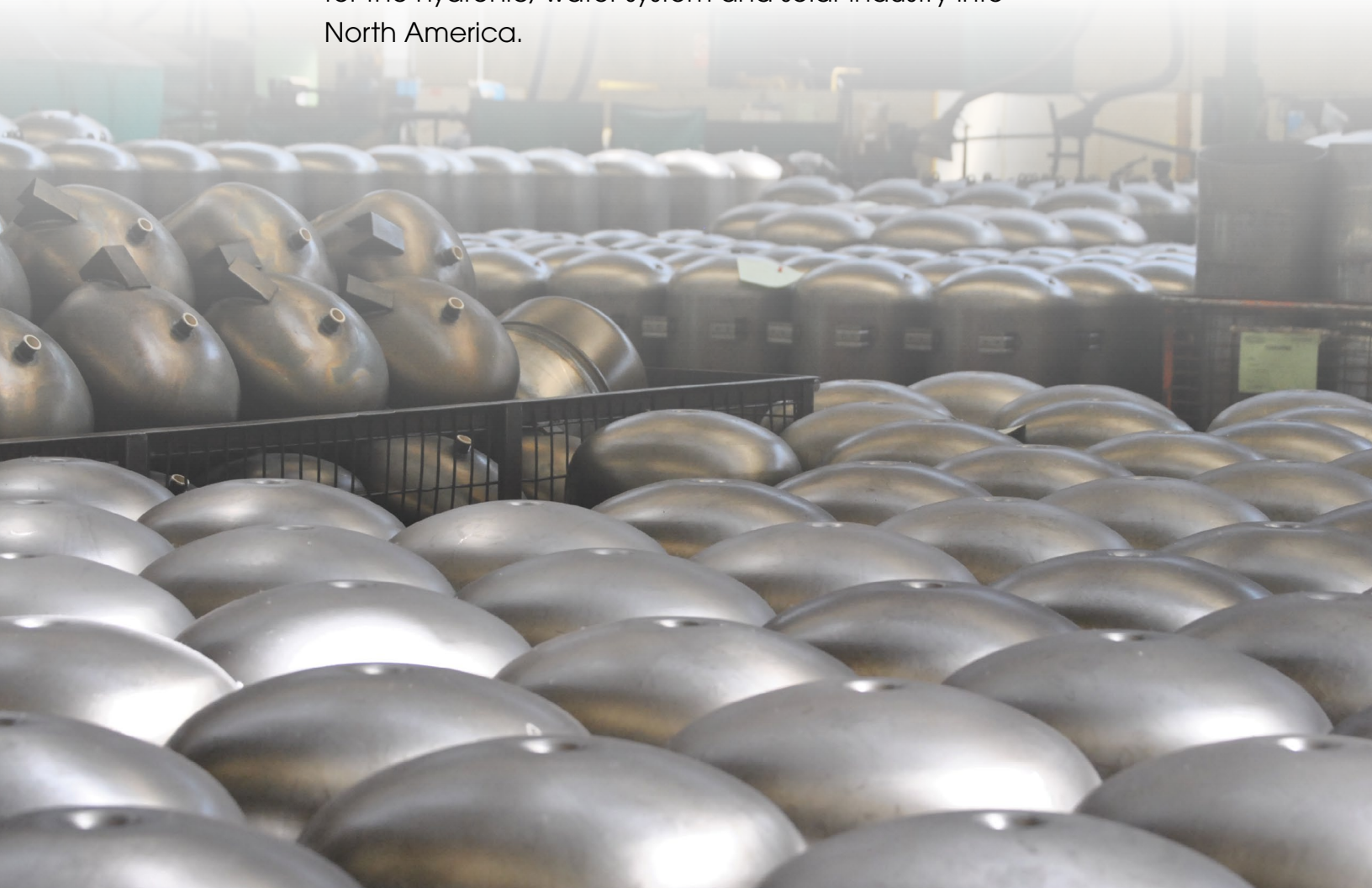

ZILMET HYDRO PLUS (ZHP) Well Tanks	4
ZILMET EASY PRO (ZEP) Thermal Expansion Tanks	5
ZILMET INOX PRO & ULTRA INOX PRO (ZS) Stainless Steel Expansion Tanks	6
ZILMET CAL PRO (ZHT) Hydronic Expansion Tanks	7
ZILMET FLATS (ZFT) Flat Hydronic Expansion Tanks	8
ZILMET SOLAR (ZSP) Solar Expansion Tanks	9
ZILMET SOLAR TANKS and Accessories	10
ZILMET ULTRA PRO (ZUP) Potable Tanks with Replaceable Bladder	11
ZILMET EXPANSION TANK ACCESSORIES	12
ZILMET HEAT EXCHANGERS	
Plate and Frame	13
Brazed Plate	15
ASME TANKS	
Zilmet Hydronic Expansion Tank with Replaceable Bladder (ZELA) ASME Rated Expansion Tank	17
Zilmet Hydronic Expansion Tank with Fixed Diaphragm (ZETA) ASME Rated Expansion Tank	18
Zilmet Thermal Expansion Tank with Replaceable Bladder (ZTXA) ASME Rated Expansion Tank	19
Zilmet Thermal Expansion Tank with Fixed Diaphragm (ZTTA) ASME Rated Expansion Tank	20
Zilmet Hydro-Pneumatic Tank with Replaceable Bladder (ZHXA) ASME Rated Expansion Tank	21
Zilmet Hydro-Pneumatic Tank with Fixed Diaphragm (ZHXT) ASME Rated Expansion Tank	23
ZILMET WARRANTY	24

ZILMET HYDRO PLUS (ZHP) Well Tanks

Stainless steel side connection allows for quicker, less expensive installation



IN LINE MODELS

Model Number:	Volume: (Gal)	Tank Weight: (Lbs)	Connection Size: (NPT)	Shipping Dimensions: (LxWxH)	System Drawdown: 30-50 (PSI) 40-60 (PSI)		UPC Code: (801985)	List Price: (US \$)
ZHP 5	2.1	6	3/4"	13" x 9" x 9"	0.7	0.5	5010791	\$75.60
ZHP 12	4.8	10	3/4"	16" x 11" x 11"	1.6	1.2	5011026	\$96.10
ZHP 18	6.3	11	1"	18" x 12" x 13"	2.0	1.7	5011026	\$141.12
ZHP104IL	9.2	19	1"	16" x 16" x 18"	3.1	2.4	5010241	\$211.39
ZHP200IL	13.2	23	1"	16" x 16" x 23"	4.4	3.4	5010258	\$272.96

STAND MODELS

Model Number:	Volume: (Gal)	Tank Weight: (Lbs)	Connection Size: (NPT)	Shipping Dimensions: (LxWxH)	System Drawdown: 30-50 (PSI) 40-60 (PSI)		UPC Code: (801985)	List Price: (US \$)
ZHP200F	13.2	25	1"	16" x 16" x 23"	4.4	3.4	5010562	\$292.10
ZHP202	21.1	35	1"	18" x 18" x 26"	7.1	5.4	5010272	\$354.32
ZHP203	27.7	40	1-1/4"	21" x 20" x 28"	9.3	7.2	5010289	\$483.80
ZHP204	39.6	54	1-1/4"	20" x 20" x 37"	13.2	10.2	5010296	\$679.56
ZHP250	52.8	64	1-1/4"	24" x 24" x 34"	15.6	13.6	5010838	\$820.24
ZHP251	66	79	1-1/4"	25" x 25" x 40"	22.0	17.1	5010302	\$888.08
ZHP302	79.3	114	1-1/4"	25" x 25" x 47"	23.4	20.5	5010845	\$1,115.20
ZHP350	105.7	128	1-1/4"	25" x 25" x 61"	35.2	27.3	5010319	\$1,505.00
ZHP351	119	115	1-1/4"	31" x 31" x 46"	37.1	32.1	5046998	\$1,856.45
ZHP400	132.1	175	1-1/4"	30" x 28" x 55"	39.1	34.1	5010852	\$2,161.80
ZHP451	158.5	182	1-1/4"	30" x 30" x 64"	52.8	40.9	5010326	\$2,600.00

SPECIALTY TANKS

Model Number:	Volume: (Gal)	Tank Weight: (Lbs)	Connection Size: (NPT)	Shipping Dimensions: (LxWxH)	System Drawdown: 30-50 (PSI) 40-60 (PSI)		UPC Code: (801985)	List Price: (US \$)
ZHP202BV*	21.1	37	1"	18" x 18" x 26"	7.1	5.4	5010555	\$380.77
ZHP200BH**	13	20	1"	22" x 15" x 18"	4.4	3.4	5010265	\$317.73
ZHP202BH**	21.1	37	1"	18" x 18" x 26"	7.1	5.4	5010814	\$380.77
ZHP202SM	21.1	35	1"	18" x 18" x 26"	7.1	5.4	5010821	\$372.83

* vertical tank with welded pump mounting bracket
 ** horizontal tank with welded pump mounting bracket

Description:	Material:	Operating Conditions:	
shell	carbon steel +	max. operating pressure	150 psi
connection	stainless steel +	operating temperature	210 °F
diaphragm	butyl	factory precharge	38 psi
color	almond	warranty	5 years

+ internally coated with epoxy for potable water applications

STAINLESS STEEL FLEX CONNECTOR

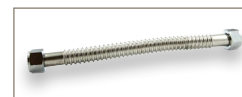

Our new connector allows for easier and faster installation in tank replacement applications

Model Number:	Length:	Item Weight:	Connections:	List Price: (US \$)
ZFLEX 1-12	12"	2 lbs	1" female	\$37.20
ZFLEX 1-18	18"	2 lbs	1" female	\$41.48
ZFLEX 2-18	18"	2 lbs	1 1/4" female	\$52.60

- please see page 12 for tank accessories

ZILMET EASY PRO (ZEP) Thermal Expansion Tanks

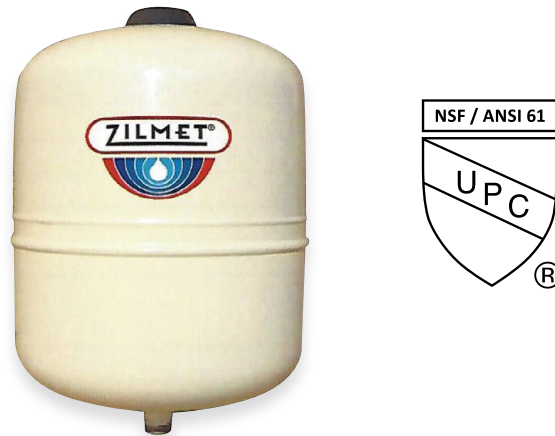

IN LINE MODELS

Model Number:	Volume: (Gal)	Tank Weight: (Lbs)	Connection Size: (NPT)	Shipping Dimensions: (LxWxH)	Acceptance Volume: (Gal)	UPC Code: (801985)	List Price: (US \$)
ZEP5	2.1	6	3/4"	13" x 9" x 9"	1.4	5041337	\$75.60
ZEP12	4.8	10	3/4"	16" x 11" x 11"	3.3	5041344	\$96.08
ZEP18	6.3	11	3/4"	18" x 12" x 13"	4.3	5041351	\$141.12
ZHP104IL	9.2	19	1"	16" x 16" x 18"	6.3	5010241	\$211.40
ZHP200IL	13.2	23	1"	16" x 16" x 23"	9	5010258	\$272.96

STAND MODELS

Model Number:	Volume: (Gal)	Tank Weight: (Lbs)	Connection Size: (NPT)	Shipping Dimensions: (LxWxH)	Acceptance Volume: (Gal)	UPC Code: (801985)	List Price: (US \$)
ZHP200F	13.2	23	1"	16" x 16" x 23"	9	5010562	\$299.18
ZHP202	21.1	35	1"	18" x 18" x 26"	14.4	5100272	\$375.90
ZHP203	27.7	40	1-1/4"	21" x 20" x 28"	18.9	5010289	\$538.65
ZHP204	39.6	54	1-1/4"	20" x 20" x 37"	27	5010296	\$762.09
ZHP250	52.8	64	1-1/4"	24" x 24" x 34"	36	5010838	\$883.43
ZHP251	66	79	1-1/4"	25" x 25" x 40"	44.9	5010302	\$1,029.00
ZHP302	79.3	114	1-1/4"	25" x 25" x 47"	54	5010845	\$1,243.20

Description:	Material:
shell	carbon steel
connection	stainless steel
diaphragm	butyl
color	almond

Operating Conditions:	
max. operating pressure	150 psi
operating temperature	210 °F
factory precharge	40 psi
warranty	5 years

ZILMET INOX PRO & ULTRA INOX PRO (ZS) Stainless Steel Expansion Tanks

All tanks
manufactured
with 304
Stainless Steel



**Zilmet Inox Pro
& Ultra Inox Pro (ZS)**

Models ZS8,
ZS12 and ZS18
are NSF61 Certified

IN LINE MODELS

INOX PRO

Model Number:	Volume: (Gal)	Tank Weight: (Lbs)	Connection Size: (NPT)	Shipping Dimensions: (LxWxH)	Acceptance Volume: (Gal)	UPC Code: (801985)	List Price: (US \$)
ZS160	0.04	0.5	1/4"	4" x 4" x 3"	N/A	N/A	\$167.16
ZS05	0.13	0.8	1/2"	4" x 4" x 5"	.1	5043355	\$214.91
ZS1	.26	1.7	1/2"	5" x 5" x 7"	.2	5043362	\$260.35
ZS2	.53	2	1/2"	6" x 6" x 8"	.3	5039945	\$275.50

IN LINE MODELS

Model Number:	Volume: (Gal)	Tank Weight: (Lbs)	Connection Size: (NPT)	Shipping Dimensions: (LxWxH)	Acceptance Volume: (Gal)	UPC Code: (801985)	List Price: (US \$)
ZS8 ♦	2.1	5	3/4"	9" x 9" x 12"	1.5	5038375	\$392.37
ZS12 ♦	3.2	6.8	3/4"	11" x 11" x 11"	3.2	5038498	\$480.34
ZS18 ♦	4.8	8.8	3/4"	11" x 11" x 15"	3.3	5043898	\$550.25

♦ NSF61 Certified

STAND MODELS

ULTRA INOX PRO

Model Number:	Volume: (Gal)	Tank Weight: (Lbs)	Connection Size: (NPT)	Shipping Dimensions: (LxWxH)	Acceptance Volume: (Gal)	UPC Code: (801985)	List Price: (US \$)
ZS24V*	6.3	11	1"	12" x 13" x 20"	4.9	5044796	\$905.00
ZS24H**+	6.3	13	1"	20" x 11" x 12"	4.9	5039983	\$930.23
ZS60V*+	15.9	33	1"	27" x 16" x 17"	12.3	5043348	\$2,198.00
ZS60H**+	15.9	31	1"	27" x 16" x 17"	12.3	5044772	\$2,200.34
ZS100V*+	26.4	42	1"	32" x 19" x 20"	20.4	5039631	\$3,146.99
ZS100H**+	26.4	44	1"	32" x 19" x 20"	20.4	5044789	\$3,163.10

* Vertical **Horizontal + Includes welded pump bracket

Inox Pro Operating Conditions:

max. operating pressure ZS160	220 psi
max. operating pressure ZS05-ZS18	150 psi
operating temperature	14 °F - 210 °F
factory precharge .04 gal - .55 gal	50 psi
factory precharge 2.1 gal - 4.8 gal	36 psi
diaphragm	butyl
warranty	5 years

Ultra Inox Pro Operating Conditions:

max. operating pressure	150 psi
operating temperature	14 °F - 210 °F
factory precharge	22 psi
replaceable bladder	butyl
warranty	5 years

- please see page 12 for tank accessories

ZILMET CAL PRO (ZHT) Hydronic Expansion Tanks



IN LINE MODELS

Model Number:	Volume: (Gal)	Tank Weight: (Lbs)	Connection Size: (NPT)	Shipping Dimensions: (LxWxH)	Acceptance Volume: (Gal)	UPC Code: (801985)	List Price: (US \$)
ZHT8	2.1	4.6	1/2"	9" x 9" x 13"	1.4	5044796	\$63.00
ZHT12	3.2	6.0	1/2"	12" x 12" x 12"	2	5039853	\$71.40
ZHT18	4.8	6.8	1/2"	12" x 12" x 16"	3	5039860	\$78.75
ZHT24	6.3	9.1	1/2"	13" x 13" x 17"	3.9	5038283	\$144.27
ZHT35	9.2	15.3	3/4"	16" x 16" x 17"	5.7	5039877	\$176.53
ZHT50	13.2	21.3	3/4"	16" x 16" x 22"	8.1	5038290	\$214.75

STAND MODELS

Model Number:	Volume: (Gal)	Tank Weight: (Lbs)	Connection Size: (NPT)	Shipping Dimensions: (LxWxH)	Acceptance Volume: (Gal)	UPC Code: (801985)	List Price: (US \$)
ZHT35F*	9.2	15.4	3/4"	16" x 16" x 17"	5.7	5042297	\$193.83
ZHT50F*	13.2	21.5	3/4"	16" x 16" x 22"	8.1	5042303	\$241.29
ZHT80	21.1	34	3/4"	18" x 18" x 25"	15.3	5038603	\$305.68
ZHT105	27.7	44	3/4"	20" x 21" x 27"	20.1	5039839	\$474.94
ZHT150	39.6	55	3/4"	21" x 21" x 37"	28.8	5039846	\$603.25
ZHT200	52.8	66	3/4"	24" x 24" x 33"	38.4	5039884	\$748.73
ZHT250	66	90.2	3/4"	25" x 25" x 40"	48	5039891	\$869.69
ZHT300	79.3	101.2	3/4"	26" x 26" x 46"	57.7	5039907	\$1,112.62
ZHT400	105.7	144.1	3/4"	26" x 26" x 61"	76.8	5038740	\$1,532.58
ZHT500	132.1	154	1"	30" x 30" x 55"	96	5039914	\$1,932.97
ZHT600	158.5	189.2	1"	30" x 30" x 62"	115.2	5038757	\$2,247.00
ZHT700	184.9	211.2	1"	30" x 30" x 70"	134.2	5039921	\$2,998.30

* with feet

Description:	Material:
shell	carbon steel
connections	carbon steel
diaphragm	SBR synthetic rubber
color	grey

Operating Conditions:	
max. operating pressure 2.1 gal	75 psi
max. operating pressure 3.2-13.2 gal	60 psi
max. operating pressure 21-184 gal	90 psi
max. operating temperature	210 °F
factory precharge	12 psi
warranty	5 years

ZILMET FLATS (ZFT) Flat Hydronic Expansion Tanks



The Space Saving Expansion Tanks



All tanks come with a fixed mounting bracket and a union connection with a two way service check valve

Model Number:	Volume: (Gal)	Tank Weight: (Lbs)	Connection Size: (NPT)	Shipping Dimensions: (LxWxH)	Acceptance Volume: (Gal)	UPC Code: (801985)	List Price: (US \$)
ZFT8C*	2.1	10	1/2"	16" x 16" x 5"	1.1	5042501	\$121.79
ZFT18C*	4.8	10	1/2"	16" x 16" x 9"	2.4	5042594	\$139.74
ZFT8R**	2.1	17	1/2"	20" x 11" x 5"	1.1	5042587	\$134.64
ZFT18R**	4.8	18	1/2"	20" x 15" x 7"	2.7	5042600	\$220.32
ZFT24R**	6.3	20	1/2"	20" x 15" x 8"	3.9	5050322	\$280.24
ZFT-U	Union connection with a two way check valve						\$32.00

* round hydronic tank with union and mounting bracket

** rectangular hydronic tank with union and mounting bracket

Operating Conditions:

factory precharge	12 psi
max. working pressure ZFT8C, ZFT18C, ZFT8R	43.5 psi
max. working pressure ZFT18R	51 psi
max. operating temperature	194° F
color	gray
warranty	5 years

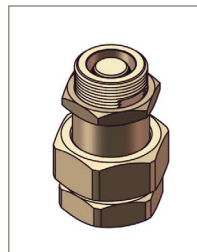

ZFT-U: Union connection with a two way check valve

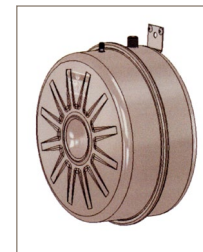

Hanging Bracket

ZILMET SOLAR PLUS (ZSP) Solar Expansion Tanks



IN LINE MODELS

Model Number:	Volume: (Gal)	Tank Weight: (Lbs)	Connection Size: (NPT)	Shipping Dimensions: (LxWxH)	Acceptance Volume: (Gal)	UPC Code: (801985)	List Price: (US \$)
ZSP12	3.2	7.7	3/4"	11" x 12" x 13"	2.2	5040750	\$87.18
ZSP18	4.8	8.8	3/4"	11" x 16" x 12"	3.3	5038313	\$116.24
ZSP24	6.6	10.4	3/4"	12" x 13" x 17"	4.6	5038320	\$132.38

STAND MODELS

Model Number:	Volume: (Gal)	Tank Weight: (Lbs)	Connection Size: (NPT)	Shipping Dimensions: (LxWxH)	Acceptance Volume: (Gal)	UPC Code: (801985)	List Price: (US \$)
ZSP35*	9.2	18.7	3/4"	16" x 16" x 17"	6.4	5038337	\$202.67
ZSP50*	13.2	24	3/4"	16" x 16" x 23"	9.1	5038306	\$242.16
ZSP80	21.1	33	1"	26" x 20" x 20"	14.6	5038214	\$309.96
ZSP105	27.7	44	1"	21" x 20" x 27"	19.2	5038221	\$455.96
ZSP150	39.6	55	1"	21" x 21" x 37"	27.4	5038238	\$651.85
ZSP200	52.8	72.6	1"	24" x 24" x 34"	36.6	5038245	\$870.37
ZSP250	66.0	94.6	1"	26" x 26" x 40"	45.7	5041542	\$1,238.48
ZSP300	79.3	112.2	1"	26" x 26" x 48"	55	5038252	\$1,640.41
ZSP400	105.7	158.4	1"	26" x 26" x 61"	73.3	5041559	\$1,940.90
ZSP500	132.1	171.6	1"	31" x 31" x 57"	91.5	5038269	\$2,132.49
ZSP600	158.5	206.8	1"	31" x 31" x 64"	109.8	5042365	\$2,440.33

* with feet

Description:	Material:
shell	carbon steel
connections	carbon steel
fixed membrane	ZILAN membrane
color	White with epoxy powder coating

Operating Conditions:	
factory precharge	36 psi
max. working pressure	150 psi
max. operating temperature	230° F
warranty	5 years

VSG TANKS – Temperature reducing pre-vessel

Model Number:	Volume: (Gal)	Tank Weight: (Lbs)	Connection Size: (NPT)	Shipping Dimensions: (LxWxH)	UPC Code: (801985)	List Price: (US \$)
VSG5	1.3	3.3	3/4"	13" x 7" x 7"	5042723	\$74.20
VSG8	2.1	4.4	3/4"	9" x 9" x 13"	5042730	\$78.08
VSG12	3.2	6.82	3/4"	14" x 11" x 11"	5042747	\$90.58
VSG18	4.8	8.14	3/4"	16" x 11" x 11"	5045748	\$106.20
VSG35	9.2	17.16	3/4"	16" x 16" x 16"	5042754	\$153.22
VSG50	13.2	22	3/4"	17" x 17" x 22"	5045885	\$184.92
VSG105	27.7	39.16	1"	20" x 21" x 27"	5046844	\$347.53

SOLARPLUS SAFE – Combination of Solar Plus and VSG in a single tank

Model Number:	Volume: (Gal)	Tank Weight: (Lbs)	Connection Size: (NPT)	Shipping Dimensions: (LxWxH)	UPC Code: (801985)	List Price: (US \$)
ZSS18	4.8+1.6	13	3/4"	12" x 12" x 21"	5042693	\$201.42
ZSS24	6.6+2.6	15	3/4"	13" x 13" x 24"	5042709	\$213.92
ZSS35	9.2+3.2	22	3/4"	17" x 17" x 31"	5042716	\$359.15

SOLAR TANK MOUNTING BRACKETS

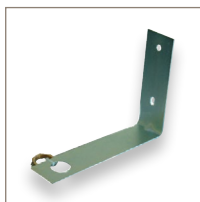

ZWH B: \$39.35



ZWH HP: \$42.15



ZWH M: \$25.01

ZILMET ULTRA PRO

Potable Tanks with Replaceable Bladder



- These tanks offer unlimited service as the bladder is easily replaceable
- A full range of replaceable bladder expansion tanks ranging from 2 gallons up to 260 gallons

VERTICAL MODELS - 10BAR

Model Number:	Volume: (Gal)	Tank Weight: (Lbs)	Connection Size: (NPT)	Shipping Dimensions: (LxWxH)	Acceptance Volume: (Gal)	UPC Code: (801985)	List Price: (US \$)
ZUP8	2.1	2.6	3/4"	13.8" x 8.1" x 8.3"	1.5	5041566	\$69.06
ZUP12V	3.2	3.2	3/4"	11" x 12.6" x 11.1"	2.4	5041573	\$76.02
ZUP18V	5	3.8	3/4"	10.9" x 16.5" x 11"	3.7	5041580	\$85.14
ZUP24V	6.3	5.3	1"	19.4" x 11" x 11.3"	4.6	5041597	\$90.36
ZUP50V	13.2	9.9	1"	30.9" x 15.2" x 15.2"	9.7	5040668	\$313.14
ZUP60V	15.9	10.2	1"	34.3" x 15.4" x 15.8"	11.7	5041610	\$327.78
ZUP80V	21.1	11.6	1"	32.9" x 18.1" x 18.4"	15.5	5040767	\$397.56
ZUP100V	26.4	15.8	1 1/2"	38.2" x 18.1" x 18.4"	19.4	5041641	\$510.60
ZUP200V	52.8	36.5	1 1/2"	51.3" x 20.9" x 22.9"	38.8	5042013	\$836.94
ZUP300V	79.3	51	1 1/2"	24.8" x 24.8" x 55.7"	58.3	5042006	\$883.44
ZUP500V	132.1	79.7	1 1/2"	29.5" x 29.5" x 63.4"	97.2	5046462	\$1,722.72
ZUP750V	198.1	142.7	1 1/2"	29.5" x 29.5" x 83.7"	134	5046448	\$3,110.64
ZUP1000	264.2	208.7	1 1/2"	33.5" x 33.5" x 84.6"	154.2	5040491	\$6,263.88

HORIZONTAL MODELS - 10BAR

Model Number:	Volume: (Gal)	Tank Weight: (Lbs)	Connection Size: (NPT)	Shipping Dimensions: (LxWxH)	Acceptance Volume: (Gal)	UPC Code: (801985)	List Price: (US \$)
ZUP24H*	6.3	5.3	3/4"	10.6" x 11.4" x 19.1"	4.6	5038337	\$111.00
ZUP50H*	13.2	9.9	1"	15" x 16.1" x 22.1"	9.7	5038306	\$313.14
ZUP60H	15.9	10.2	1"	15" x 16.1" x 25.2"	11.7	5038214	\$327.78
ZUP80H	21.1	11.6	1"	17.7" x 18.9" x 25.2"	15.5	5038221	\$397.56
ZUP100H	26.4	15.8	1"	17.7" x 18.9" x 28.7"	19.4	5038238	\$510.60
ZUP200H	52.8	36.5	1 1/2"	21.7" x 22.8" x 38.8"	38.8	5038245	\$836.94
ZUP300H	79.3	51	1 1/2"	24.8" x 26" x 44.9"	58.3	5041542	\$1,060.14

* with feet

Description:	Material:
shell	carbon steel
connections	carbon steel
fixed membrane	butyl
color	White with epoxy powder coating

Operating Conditions:	
factory precharge	28 psi
max. working pressure	150 psi
max. operating temperature	210° F
warranty	5 years

STAINLESS STEEL FLEX CONNECTOR



Our new connector allows for easier and faster installation in tank replacement applications

Model Number:	Length:	Item Weight:	Connections:	List Price: (US \$)
ZFLEX 1-12	12"	2 lbs	1" female	\$37.20
ZFLEX 1-18	18"	2 lbs	1" female	\$41.48
ZFLEX 2-18	18"	2 lbs	1 1/4" female	\$52.60

UNION CONNECTION

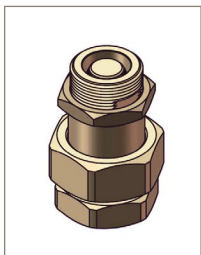

Union connection with a two way check valve for hydronic use only

ZFT-U: **\$32.00**

SOLAR TANK MOUNTING BRACKETS

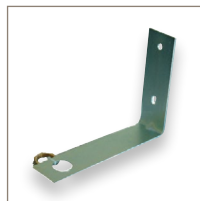

ZWH B: **\$39.35**



ZWH HP: **\$42.15**

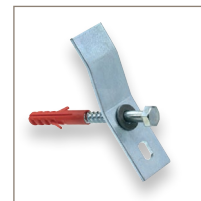

ZWH M: **\$25.01**

TANK TEES WITH UNION



ZTT-1
1" connection size
List Price: **\$49.00**



ZTT-2
1 1/4" connection size
List Price: **\$68.60**

TANK TEE KITS

ZTK-1
ZILMET TANK T KIT – No Lead Tank T Fitting Package with ZTT-1 for 1" connection.
List Price: **\$115.34**

ZTK-2
ZILMET TANK T KIT – No Lead Tank T Fitting Package with ZTT-2 for 1 1/4" connection.
List Price: **\$134.34**

Package Contains:

- No Lead Brass Tank Tee with Swivel Union Nut
- 40/60 Pressure Switch
- No Lead Pressure Gauge 0-100 psi
- 1/4" NPT X 3" No Lead Brass Nipple
- 1/2 NPT No Lead Brass Boiler Drain with Hose Bibb
- 1/2" No Lead Pressure Relief Valve

Ultra Pro Replacement Membranes	List Price: (US \$)
Replacement membrane for 24L Ultra Pro Tank	\$341.80
Replacement membrane for 60-80L Ultra Pro Tank	\$385.20
Replacement membrane for 100L Ultra Pro Tank	\$424.40
Replacement membrane for 200L Ultra Pro Tank	\$786.00
Replacement membrane for 300L Ultra Pro Tank	\$980.80
Replacement membrane for 500L Ultra Pro Tank	\$1,598.24
Replacement membrane for 750-1000L Ultra Pro tank	\$1,960.60

GENERAL INFORMATION:

- Applications: The Zilmet plate heat exchanger has many applications. These include: production of sanitary hot water, decoupling of thermal circuits, district heating systems, recovery of heat coming from industrial process, cooling or heating of alimentary fluids (milk, beer, wine, etc), cooling of industrial machineries, heating of water for swimming pools and solar systems.
- Advantages: In every situation which requires a thermal exchange between two fluids, Zilmet plate heat exchangers are the right choice. The high efficiency, the long life, the low price, the small dimensions, the high modularity, the easy maintenance and the high reliability are some of the most important advantages of Zilmet plate heat exchangers.



TECHNICAL FEATURES:

- Plates: The plates are manufactured with 316 L stainless steel .0197 inches thick. This kind of material and thickness allows a smooth and quick transition to assure great corrosion resistance.
- Gaskets: Zilmet plate heat exchangers are equipped with glued EPDM gaskets with a maximum working temperature of 284 F. For particular applications, such as gasoline and oils, they can be equipped on request with nitril glued gaskets, for a maximum working temperature of 230 F.
- Frames: The frames are manufactured with silver painted carbon steel. The thickness is designed for the respective working pressure.
- Tests: 100% of Zilmet plate heat exchangers are tested before shipment at 1.5 times the maximum working pressure.
- **Custom heat exchangers are available upon request. Please contact us for custom pricing.**

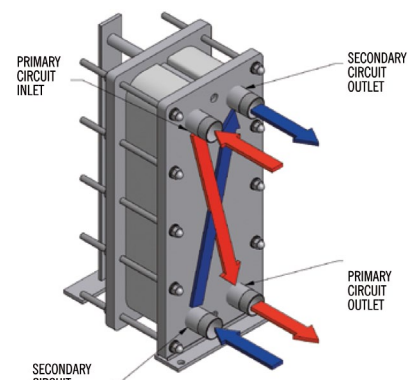
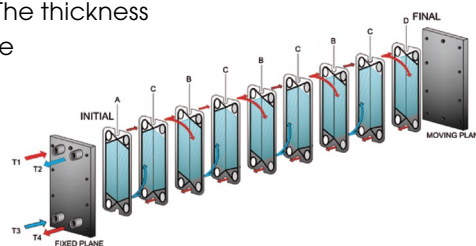

ZILMET PLATE AND FRAME Heat Exchanger

			Z2/10	Z2/16	Z3/10	Z3/16	Z4/16
Frame	Length	in	7,09	7,09	13,38	13,38	14,57
	Height	in	18,90	18,90	30,71	30,71	40,94
	Thickness	in	0,47	0,55	0,98	1,18	1,38
Plates	Exchange surface	in ²	52,70	52,70	201,50	201,50	341,00
	Thickness	in	0,02	0,02	0,02	0,02	0,02
Tie rods	Length (nr of plates)	in	4,72(7-13)	4,72 (7-13)	13,78 (7-49)	13,78 (7-51)	19,68 (21-73)
			5,90 (15-21)	5,90 (15-21)	21,65 (51-75)	21,65 (53-75)	39,37 (>75)
			9,45 (23-35)	9,45 (23-35)	25,59 (77-101)	25,59 (77-101)	
			11,81 (37-45)	11,81 (37-55)			
Guide Carrying bars	Length (nr of plates)	in	4,92 (7-13)	4,92 (7-13)	13,78 (7-49)	13,78 (7-51)	19,68 (21-73)
			5,71 (15-21)	5,71 (15-21)	21,65 (51-75)	21,65 (53-75)	39,37 (>75)
			9,84 (23-35)	9,84 (23-35)	25,59 (77-101)	25,59 (77-101)	
			11,81 (37-45)	11,81 (37-55)			
Standard connections	in	1" F	1" F	2" M inox 304	2" M inox 304	3" F	
Connection distance	in	14,57/2,56	14,57/2,56	23,78/5,71	23,78/5,71	33,46/6,61	
Distance between the plates	in	0,12	0,12	0,13	0,13	0,14	
Approximate weights	Lb	35,93+0,59 x n°P	40,78+0,59 x n°P	220,46+1,76 x n°P	264,55+1,76x n°P	462,97+2,64 x n°P	
Nominal pressure	psi	145	232	145	232	232	
Test pressure	psi	217,5	348	217,5	348	348	
Max. working temperature (with standard EPDM gaskets)	°F	284	284	284	284	230	
Max. working temperature (with NBR gaskets)	°F	230	230	230	230	230	

HEATING SYSTEMS AND GENERAL APPLICATION

Zilmet heat exchangers, made of high quality 316 stainless steel and pure copper are particularly suitable to a wide variety of applications, including:

- Boiler components
- Hot water production with tank, Hot water immediate production
- Traditional boiler heating
- Pool heating
- Thermal circuits decoupling
- District heating
- Solar system

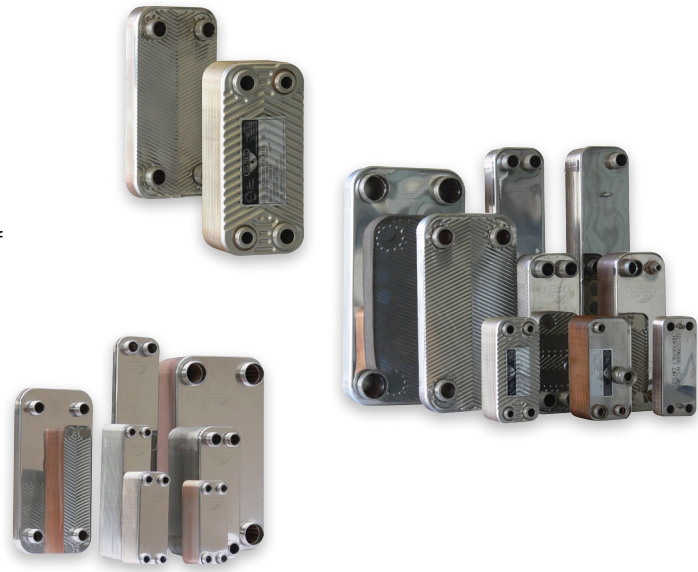

- Full line available.
- Ideal for hydronic and refrigeration use

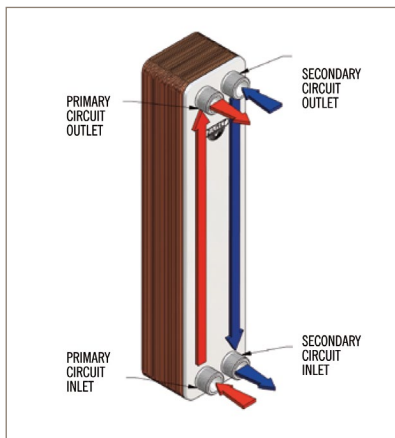

REFRIGERATION/AIR CONDITIONING FIELD

Zilmet has recently extended its range of brazed plate heat exchangers introducing a range of products dedicated to the refrigeration and air conditioning area. The new series has been designed and built for evaporation and condensing units; and they are also compatible with various types of refrigerants, including high-pressure ones such as 'R410A'.

Please contact us for more information on these refrigeration heat exchangers.

Zilmet heat exchangers are in full compliance with all safety and functionality requirements of Directive 97/23 / EC on pressure equipment.

Custom sizes and configurations available upon request.

ZILMET BRAZED PLATE Heat Exchanger

Model Number:	Weight: (Lbs)	Connection Size: (NPT)	List Price: (US \$)
ZB190 - 20 plates	2.4	3/4"	\$352.10
ZB207 - 14 plates	1.8	3/4"	\$391.14
ZB207 - 20 plates	2.4	3/4"	\$462.10
ZB207 - 30 plates	3.5	3/4"	\$550.17
ZB207 - 36 plates	4.1	3/4"	\$582.26
ZB207 - 40 plates	4.6	3/4"	\$633.96
ZB315 - 10 plates	2.3	3/4"	\$625.86
ZB315 - 16 plates	3.2	3/4"	\$696.38
ZB315 - 20 plates	3.9	3/4"	\$758.79
ZB315 - 24 plates	4.6	3/4"	\$814.37
ZB315 - 30 plates	5.5	3/4"	\$906.71
ZB315 - 40 plates	7.2	3/4"	\$1,057.19

Description:	Material:
Shaped plates material	Stainless Steel AISI 316L
Brazing material	99% Copper
Connection material	Stainless Steel AISI 316L

Operating Conditions:	
Max working pressure primary circuit	72.5 PSI
Max working pressure secondary circuit	145 PSI
Max operating temperature	14°F / 248°F

Model Number:	Weight: (Lbs)	Connection Size: (NPT)	List Price: (US \$)
ZB250 - 20 plates	8.4	1"	\$780.24
ZB250 - 30 plates	11.0	1"	\$962.73
ZB250 - 40 plates	13.7	1"	\$1,169.19
ZB250 - 50 plates	16.3	1"	\$1,390.64
ZB250 - 60 plates	19	1"	\$1,594.58
ZB250 - 70 plates	21.6	1"	\$1,719.41
ZB250 - 90 plates	26.9	1"	\$2,210.58
ZB500 - 20 plates	14.6	1"	\$1,184.45
ZB500 - 30 plates	19.6	1"	\$1,518.80
ZB500 - 40 plates	24.5	1"	\$1,848.45
ZB500 - 60 plates	34.4	1"	\$2,512.21
ZB450 - 40 plates	48.6	2"	\$2,649.56
ZB450 - 50 plates	58.4	2"	\$3,058.92
ZB450 - 70 plates	78.2	2"	\$3,616.16

Description:	Material:
Shaped plates material	Stainless Steel AISI 316L
Brazing material	99% Copper
Connection material	Stainless Steel AISI 316L

Operating Conditions:	
Max working pressure primary circuit	435 PSI
Max working pressure secondary circuit	435 PSI
Max operating temperature	-58°F / 392°F

- Please call for pricing **401.884.4943**

Zilmet Hydronic Expansion Tank with Replaceable Bladder (ZELA) ASME Rated Expansion Tank

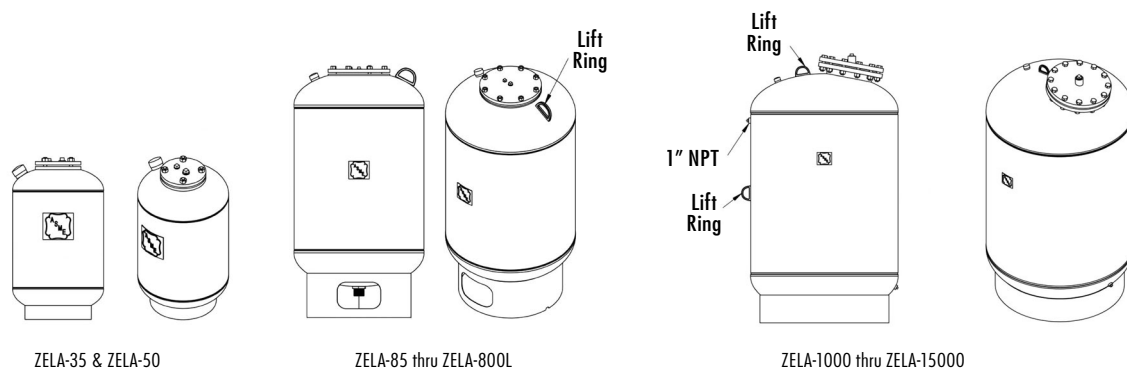

Model Number:	Volume: (Gal)	Tank Weight: (Lbs)	Connection Size: (NPT)	Shipping Dimensions: (LxWxH)	List Price: (US \$)
ZELA-35	10	40	3/4"	12" x 12" x 23.5"	\$2,795.84
ZELA-50	13	50	3/4"	14" x 14" x 24"	\$3,079.48
ZELA-85	23	90	1"	16" x 16" x 37"	\$3,700.78
ZELA-130	35	125	1"	20" x 20" x 37"	\$4,754.29
ZELA-200	53	210	1 1/2"	24" x 24" x 43"	\$5,503.90
ZELA-300	79	225	1 1/2"	24" x 24" x 55"	\$6,030.65
ZELA-400	106	300	1 1/2"	30" x 30" x 49"	\$6,158.96
ZELA-500	132	335	1 1/2"	30" x 30" x 57"	\$6,489.87
ZELA-600	158	360	1 1/2"	30" x 30" x 65"	\$9,582.86
ZELA-800L	211	475	1 1/2"	32" x 32" x 76"	\$10,589.09

factory precharge: 12 psi

Model Number:	Volume: (Gal)	Tank Weight: (Lbs)	Connection Size: (NPT)	Shipping Dimensions: (LxWxH)	List Price: (US \$)
ZELA-1000	264	710	1 1/2"	36" x 36" x 75"	\$12,979.74
ZELA-1200	317	720	1 1/2"	36" x 36" x 87"	\$13,574.03
ZELA-1400	370	875	1 1/2"	36" x 36" x 99"	\$14,776.10
ZELA-1600	422	1100	1 1/2"	48" x 48" x 74"	\$20,347.53
ZELA-2000	528	1280	1 1/2"	48" x 48" x 87"	\$22,319.48
ZELA-2500	660	1435	2"	48" x 48" x 95"	\$29,186.86
ZELA-3000L	792	1550	2"	48" x 48" x 122"	\$36,756.57
ZELA-3000S	792	2169	2"	60" x 60" x 80"	\$51,182.86
ZELA-4000	1056	2638	2"	60" x 60" x 102"	\$54,874.86
ZELA-5000	1320	3246	2"	60" x 60" x 125"	\$57,274.29
ZELA-7500	1980	4005	3"	72" x 72" x 127"	\$92,901.71
ZELA-10000	2640	4845	3"	72" x 72" x 159"	\$108,590.86
ZELA-15000	3963	5925	3"	72" x 72" x 233"	\$165,865.14

factory precharge: 12 psi

Description:	Material:
shell	carbon steel
connection	carbon steel
bladder	heavy duty butyl

Operating Conditions:	
max. operating pressure	125 PSIG*
max. operating temperature	240 °F
warranty	1 year

Sight glass and seismic restraints available upon request

*200 & 250 PSIG available

Zilmet Hydronic Expansion Tank with Fixed Diaphragm (ZETA) ASME Rated Expansion Tank

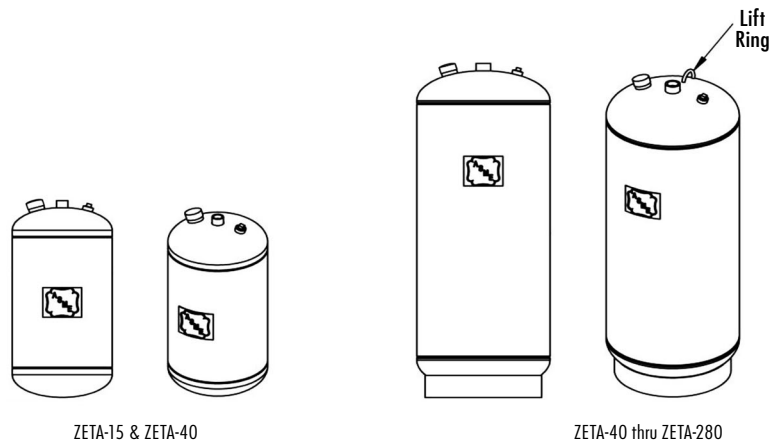

Model Number:	Volume: (Gal)	Tank Weight: (Lbs)	Connection Size: (NPT)	Shipping Dimensions: (LxWxH)	Acceptance Volume:	List Price: (US \$)
ZETA-15	7.8	42	3/4"	12" x 12" x 19"	6.3	\$1,229.09
ZETA-20	10.9	52	3/4"	12" x 12" x 25"	8.8	\$1,262.86
ZETA-40	25	84	1"	16" x 16" x 34"	20.2	\$1,951.69
ZETA-60	35	97	1"	16" x 16" x 45"	28	\$2,255.58
ZETA-80	45	148	1"	20" x 20" x 39"	36	\$2,903.90
ZETA-100	60	175	1"	20" x 20" x 50"	48.5	\$3,045.71
ZETA-120	70	259	1 1/2"	24" x 24" x 47"	56.5	\$3,754.81
ZETA-144	80	268	1 1/2"	24" x 24" x 50"	65	\$4,024.94
ZETA-180	90	283	1 1/2"	24" x 24" x 53"	73	\$4,639.48
ZETA-200	115	325	1 1/2"	24" x 24" x 67"	93	\$4,754.29
ZETA-240	140	362	1 1/2"	24" x 24" x 79"	113.5	\$5,524.16
ZETA-260	158	591	1 1/2"	30" x 30" x 64"	128	\$7,621.49
ZETA-280	211	752	1 1/2"	30" x 30" x 82"	171	\$8,785.67

Description:	Material:
shell	carbon steel
connection	carbon steel
bladder	heavy duty butyl

Operating Conditions:	
precharge of	12 psi
max. operating pressure	125 PSIG
ZETA-15 thru ZETA-60	150 PSIG
ZETA-80 thru ZETA-280	125 PSIG
max. operating temperature	240 °F
warranty	1 year

Sight glass and seismic restraints available upon request

Zilmet Thermal Expansion Tank with Replaceable Bladder (ZTXA) ASME Rated Expansion Tank

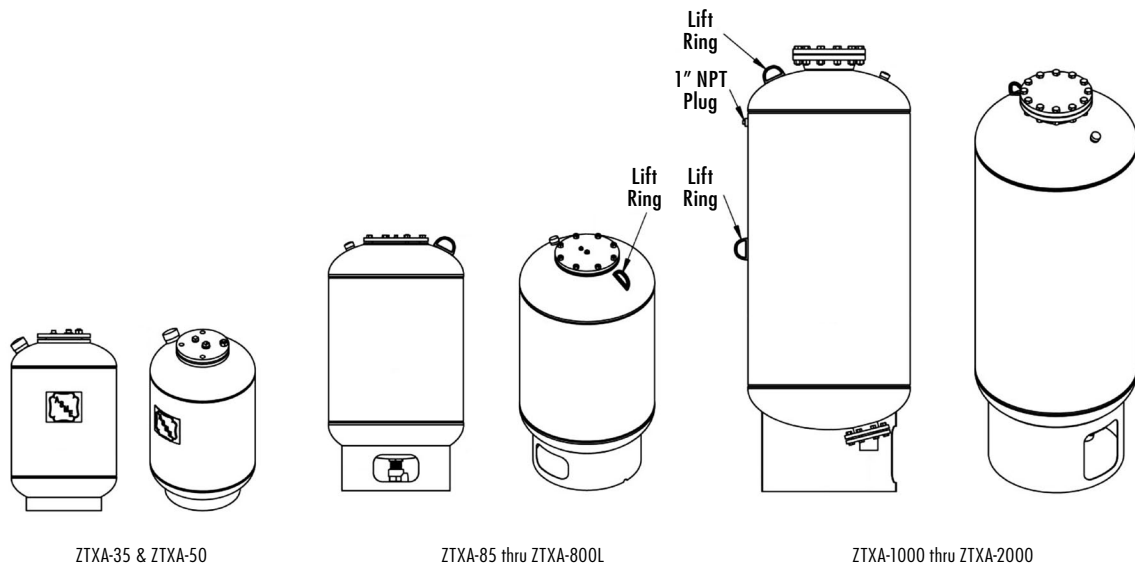

Model Number:	Volume: (Gal)	Tank Weight: (Lbs)	Connection Size: (NPT)	Shipping Dimensions: (LxWxH)	List Price: (US \$)
ZTXA-35	10	40	3/4"	12" x 12" x 23.5"	\$4,486.67
ZTXA-50	13	50	3/4"	14" x 14" x 24"	\$4,786.67

Model Number:	Volume: (Gal)	Tank Weight: (Lbs)	Connection Size: (NPT)	Shipping Dimensions: (LxWxH)	List Price: (US \$)
ZTXA-85	23	90	1"	16" x 16" x 37"	\$4,906.67
ZTXA-130	35	132	1"	20" x 20" x 37"	\$5,226.67
ZTXA-200	53	220	1 1/2"	24" x 24" x 43"	\$7,273.33
ZTXA-300	79	236	1 1/2"	24" x 24" x 55"	\$10,120.00
ZTXA-400	106	315	1 1/2"	30" x 30" x 49"	\$11,800.00
ZTXA-500	132	347	2"	30" x 30" x 57"	\$12,333.33
ZTXA-600	158	378	2"	30" x 30" x 65"	\$13,613.33
ZTXA-800L	211	503	2"	32" x 32" x 76"	\$14,893.33

Model Number:	Volume: (Gal)	Tank Weight: (Lbs)	Connection Size: (NPT)	Shipping Dimensions: (LxWxH)	List Price: (US \$)
ZTXA-1000	264	795	3"	36" x 36" x 86.5"	\$17,273.33
ZTXA-1200	317	820	3"	36" x 36" x 98.5"	\$18,333.33
ZTXA-1400	370	980	3"	36" x 36" x 110.5"	\$19,460.00
ZTXA-1600	422	1395	3"	48" x 48" x 84"	\$25,466.67
ZTXA-2000	528	1525	3"	48" x 48" x 96"	\$27,186.67

Description:	Material:
shell	carbon steel
connection	stainless steel
bladder	heavy duty butyl (FDA Approved)

Operating Conditions:	
precharge of	40 psi
max. operating pressure	150 PSIG
max. operating temperature	240 °F
warranty	1 year

Sight glass and seismic restraints available upon request

Zilmet Thermal Expansion Tank with Fixed Diaphragm (ZTTA) ASME Rated Expansion Tank

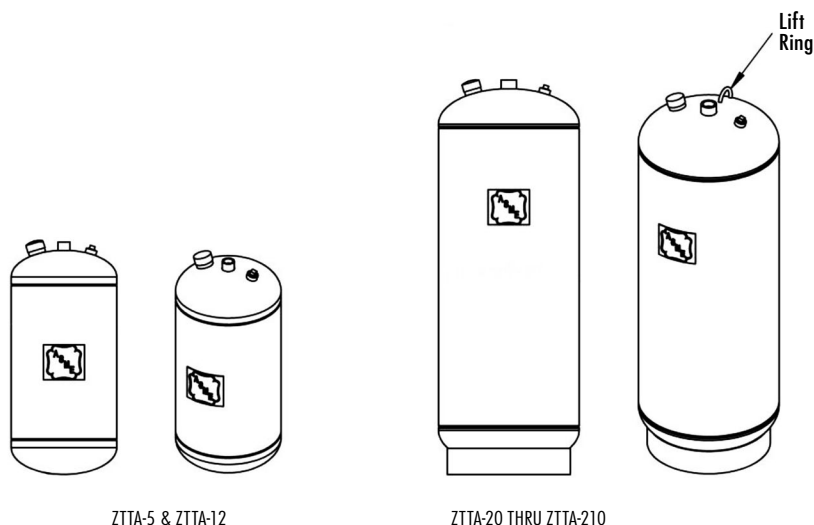

Model Number:	Volume: (Gal)	Tank Weight: (Lbs)	Connection Size: (NPT)	Shipping Dimensions: (LxWxH)	Acceptance Volume: (Gal)	List Price: (US \$)
ZTTA-5	3.5	22	3/4"	10" x 10" x 14"	2.3	\$1,865.50
ZTTA-12	5	28	3/4"	12" x 12" x 14"	3.3	\$2,200.00
ZTTA-20	8	34	3/4"	12" x 12" x 20"	5.3	\$2,440.00
ZTTA-30	15	64	3/4"	16" x 16" x 23"	10	\$2,753.33
ZTTA-42	22	88	1"	16" x 16" x 31"	14.5	\$2,940.00
ZTTA-60	26	93	1"	16" x 16" x 34"	17.5	\$3,626.67
ZTTA-80	35	109	1"	16" x 16" x 45"	23.5	\$3,840.00
ZTTA-100	45	148	1"	20" x 20" x 39"	30	\$4,066.67
ZTTA-125	60	175	1"	20" x 20" x 50"	40	\$4,533.33
ZTTA-160	70	259	1"	24" x 24" x 47"	47	\$5,013.33
ZTTA-180	80	268	1"	24" x 24" x 50"	53	\$5,473.33
ZTTA-210	90	283	1"	24" x 24" x 53"	60	\$5,760.00

Description:	Material:
shell	carbon steel
connection	stainless steel
bladder	heavy duty butyl (FDA Approved)

Operating Conditions:	
precharge of	40 psi
max. operating pressure	150 PSIG
max. operating temperature	240 °F
warranty	1 year

Sight glass and seismic restraints available upon request

Zilmet Hydro-Pneumatic Tank with Replaceable Bladder (ZHXA) ASME Rated Expansion Tank

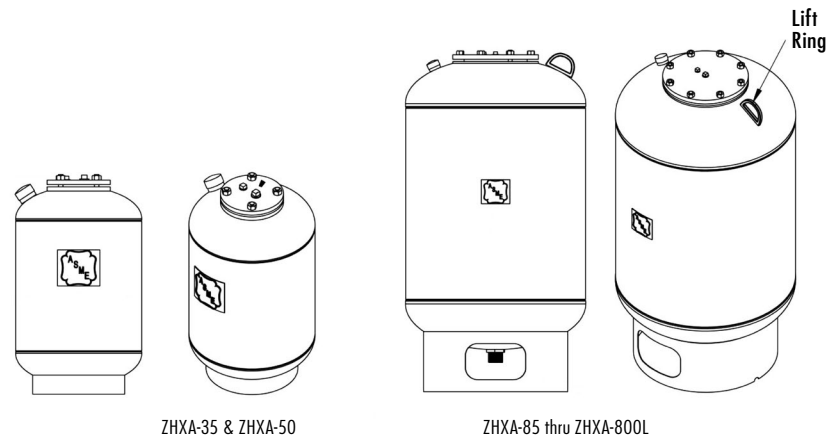

Model Number:	Volume: (Gal)	Tank Weight: (Lbs)	Connection Size: (NPT)	Shipping Dimensions: (LxWxH)	List Price: (US \$)
ZHXA-35	10	40	3/4"	12" x 12" x 23.5"	\$2,957.92
ZHXA-50	13	50	3/4"	14" x 14" x 24"	\$3,160.52
ZHXA-85	23	90	1"	16" x 16" x 37"	\$4,126.23
ZHXA-130	35	125	1"	20" x 20" x 37"	\$5,118.96
ZHXA-200	53	210	1 1/2"	24" x 24" x 43"	\$6,267.01
ZHXA-300	79	225	1 1/2"	24" x 24" x 55"	\$7,516.36
ZHXA-400	106	300	1 1/2"	30" x 30" x 49"	\$8,867.01
ZHXA-500	132	330	2"	30" x 30" x 57"	\$9,245.19
ZHXA-600	158	360	2"	30" x 30" x 65"	\$12,398.96
ZHXA-800L	211	475	2"	32" x 32" x 76"	\$14,256.10

Model Number:	Volume: (Gal)	Tank Weight: (Lbs)	Connection Size: (NPT)	Shipping Dimensions: (LxWxH)	List Price: (US \$)
ZHXA-700	185	600	1 1/2"	30" x 30" x 80"	\$14,101.99

Description:	Material:
shell	carbon steel
connection	epoxy lined
bladder	heavy duty butyl (FDA Approved)

Operating Conditions:	
precharge of	30 psi
max. operating pressure	125 PSIG*
max. operating temperature	240 °F
warranty	1 year

*200 & 250 PSIG available

Sight glass and seismic restraints available upon request

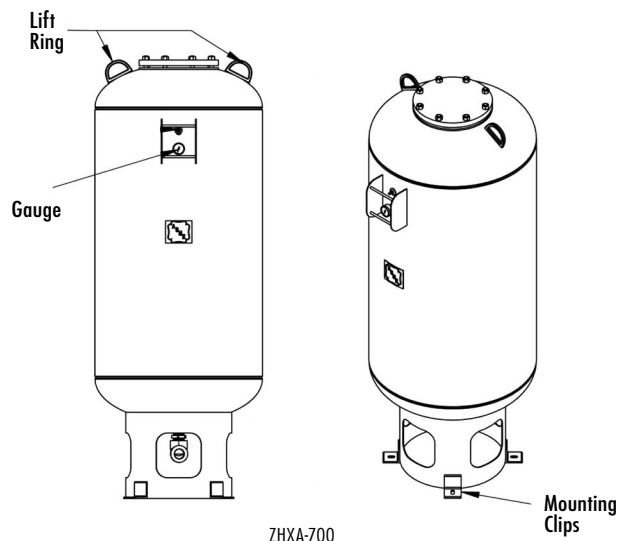

Zilmet Hydro-Pneumatic Tank with Replaceable Bladder (ZHXA) ASME Rated Expansion Tank

-continued

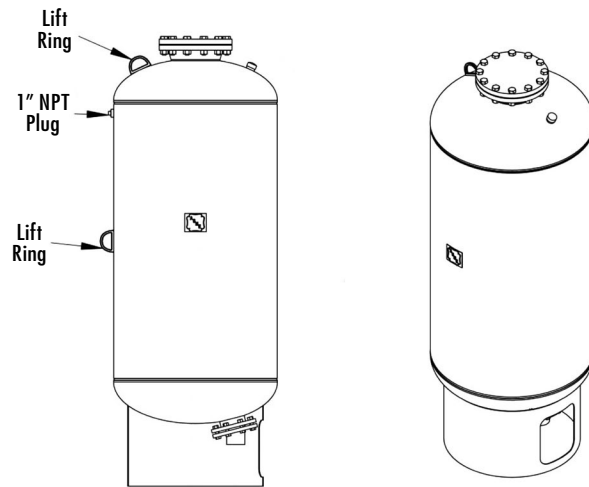

ZHXA-1000 THRU ZHXA-15000

Model Number:	Volume: (Gal)	Tank Weight: (Lbs)	Connection Size: (NPT)	Shipping Dimensions: (LxWxH)	List Price: (US \$)
ZHXA-1000	264	735	3"	36" x 36" x 87"	\$17,382.86
ZHXA-1200	317	745	3"	36" x 36" x 98.5"	\$18,503.90
ZHXA-1400	370	900	3"	36" x 36" x 110.5"	\$19,624.94
ZHXA-1600	422	1210	3"	48" x 48" x 84"	\$24,953.25
ZHXA-2000	528	1305	3"	48" x 48" x 96"	\$27,188.57
ZHXA-2500	660	1430	4"	48" x 48" x 110"	\$33,712.21
ZHXA-3000L	792	1575	4"	48" x 48" x 138"	\$36,845.71
ZHXA-3000S	792	2169	4"	60" x 60" x 93"	\$48,015.58
ZHXA-4000	1056	2638	4"	60" x 60" x 115"	\$56,247.79
ZHXA-5000	1320	3246	4"	60" x 60" x 138"	\$73,644.16
ZHXA-7500	1980	4080	4"	72" x 72" x 140"	\$204,826.44
ZHXA-10000	2640	4920	4"	72" x 72" x 172"	\$325,402.20
ZHXA-15000	3963	6000	4"	72" x 72" x 243"	\$399,482.72

Description:	Material:
shell	carbon steel
connection	epoxy lined
bladder	heavy duty butyl (FDA Approved)

Operating Conditions:	
precharge of	30 psi
max. operating pressure	125 PSIG*
max. operating temperature	240 °F
warranty	1 year

Sight glass and seismic restraints available upon request

*200 & 250 PSIG available

Zilmet Hydro-Pneumatic Tank with Fixed Diaphragm (ZHXT) ASME Rated Expansion Tank

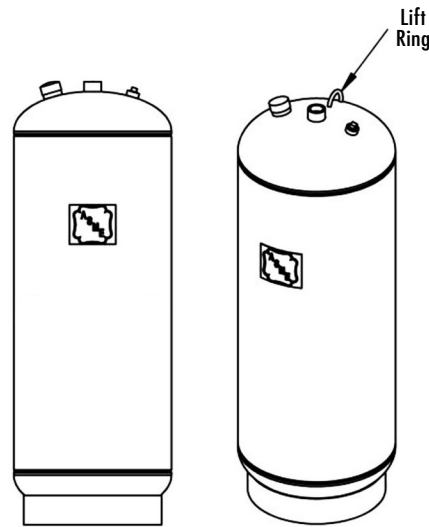

ZHXT-400 thru ZHXT-480

Model Number:	Volume: (Gal)	Tank Weight: (Lbs)	Connection Size: (NPT)	Shipping Dimensions: (LxWxH)	Acceptance Volume: (Gal)	List Price: (US \$)
ZHXT-400	8	34	3/4"	12" x 12" x 21"	3.1	\$2,994.34
ZHXT-401	15	64	1"	16" x 16" x 26"	10.5	\$3,180.78
ZHXT-402	25	84	1"	16" x 16" x 34"	12	\$3,741.30
ZHXT-403	35	97	1"	16" x 16" x 46"	12	\$3,802.08
ZHXT-404	70	259	1 1/2"	24" x 24" x 47"	52.8	\$5,692.99
ZHXT-405	90	283	1 1/2"	24" x 24" x 53"	52.8	\$5,936.10
ZHXT-415	115	325	1 1/2"	24" x 24" x 67"	52.8	\$11,846.29
ZHXT-440	140	362	1 1/2"	24" x 24" x 79"	52.8	\$13,679.12
ZHXT-460	160	591	1 1/2"	30" x 30" x 62"	56	\$16,398.20
ZHXT-480	210	752	1 1/2"	30" x 30" x 80"	84	\$19,645.08

Description:	Material:
shell	carbon steel
connection	epoxy lined
bladder	heavy duty butyl (FDA Approved)

Operating Conditions:	
precharge of	30 psi
max. operating pressure	125 PSIG*
max. operating temperature	240 °F
warranty	5 years

Sight glass and seismic restraints available upon request

*200 & 250 PSIG available

WARRANTY:

Product:	Model:	Warranty Duration:
Well Tanks	Hydro Plus (ZHP)	5 Year Limited Manufacturer's Warranty
Thermal Expansion Tanks	Easy Pro (ZEP)	5 Year Limited Manufacturer's Warranty
Hydronic Expansion Tanks	Cal Pro (ZHT)	5 Year Limited Manufacturer's Warranty
Hydronic Flat Expansion Tanks	Zilmet Flats (ZFT)	5 Year Limited Manufacturer's Warranty
Stainless Steel Tanks	Inox Pro (ZS) and Ultra Inox Pro (ZUP)	5 Year Limited Manufacturer's Warranty
Solar Expansion Tanks and Pre Solar Vessels	Solar Plus (ZSP) Pre Solar (VSG)	5 Year Limited Manufacturer's Warranty
Heat Exchanger	Brazed Plate and Frame	1 Year Limited Manufacturer's Warranty
ASME	All Models	1 Year Limited Manufacturer's Warranty





ZILMET USA CORP • 400 FRENCHTOWN ROAD, EAST GREENWICH, RHODE ISLAND 02818
P:401-884-4943 • F:401-287-4951 • INFO@ZILMETUSA.COM • WWW.ZILMETUSA.COM